



REGENT SKYLIGHTS

" Bring Natural Light Indoors "

LEAD-FREE TILE SKYLIGHT

INSTALLATION INSTRUCTION SHEET

FITS MOST TILE ROOF PROFILES

*Adapters can be supplied on request for Wunderlich & similar high profile tiles. P.O.A

1

Raw edges of components of Regent Skylights & cut edges of roofing iron are sharp. Care must be taken to avoid injury during installation.

REVERSE SIDE FLASHING BEFORE INSTALLATION



2

Remove dome glazing from Skylight base (if supplied assembled), by drilling out pop rivets from trim glazing section

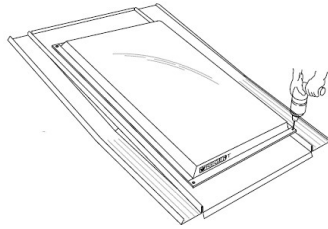

3

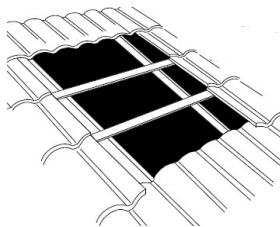

Remove required amount of tiles to allow base to be positioned correctly.

4

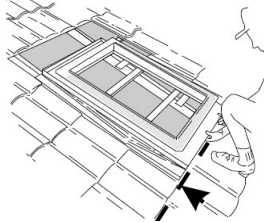

Place base in position, making sure the front apron is in line with the tile row.

NOTE: Alignment of front of Skylight is important for correct appearance.

5

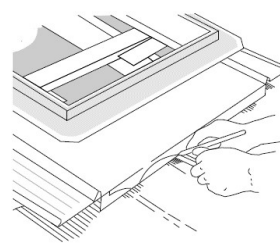

Mark front apron to tile profile using a small piece of timber to follow the profile shape

6

WARNING: Before notching out profile, check Skylight is in the desired position, as once notching is completed, the unit cannot be moved sideways.

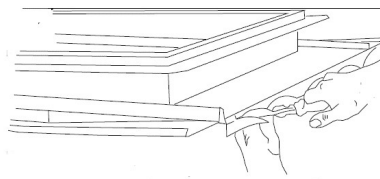

Now notch to profile

7

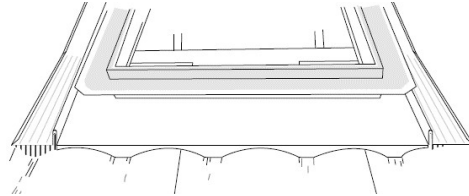

Make sure front apron is in line with the tile fronts before proceeding to step 8. Base should now be in position, with profile correct.

8

Nail fixing tabs to rafter or truss

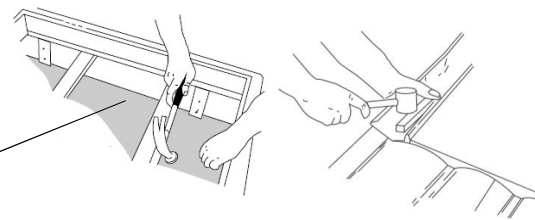

Gently tap malleable flashing to tile profile using a small piece of timber & mallet

9

Proceed to lay tiles over side flashing only, ensuring tiles are neatly seated against tray.

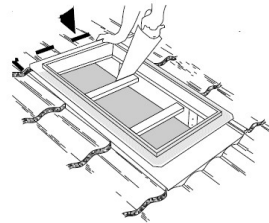

NOTE: Do NOT lay tiles over top of Zinalume steel flashing tray, except at rear of Skylight.

Cut out battens to leave clear opening.

10

Replace dome glazing & trim section to unit. Rivet ONLY at corners, DO NOT rivet through glazing.

Your Regent Lead-free TILE Skylight is complete

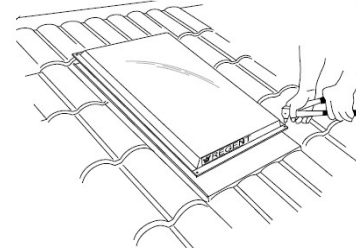

The Skylight system illustrations contained in this brochure are the sole property of Regent Skylights and are reserved under copyright law. It is the responsibility of the user to ensure that the selected skylight system complies with the relevant building codes and authorities requirements. Regent Systems reserves the right to improve or modify the skylight systems at any time.

Technical Sheet INST/SZTS/23042020/001.8

www.regentskylights.com.au



REGENT SKYLIGHTS

" Bring Natural Light Indoors "